

BORON CARBIDE INSERT SS-6

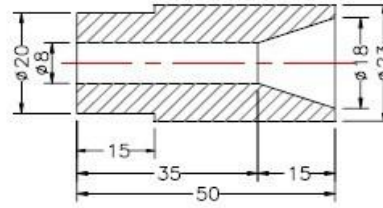

BORON CARBIDE INSERT SS-8

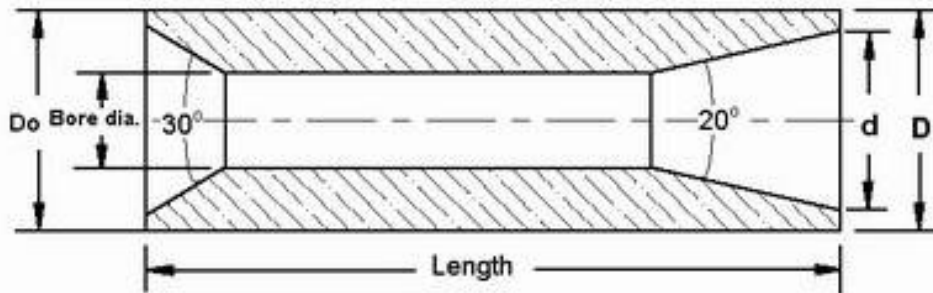

1

"K" shape Boron carbide long venturi nozzles

Item	Length	Bore dia.	d	D	D ₀
HB50-1	50	6.4	10	20.5	14.5
HB50-2	50	7.9	12	20.5	14.5
HB50-3	50	9.5	12	20.5	14.5
HB50-4	50	11	14	20.5	14.5
HB50-5	50	12.7	14	20.5	14.5
HB70-1	70	6.4	12	22.2	18
HB70-2	70	7.9	14	22.2	18
HB70-3	70	9.5	14	22.2	18
HB70-4	70	11	16	22.2	18
HB70-5	70	12.7	16	22.2	18
HB80-1	80	6.4	12	22.2	18
HB80-2	80	7.9	14	22.2	18
HB80-3	80	9.5	14	22.2	18
HB80-4	80	11	16	22.2	18
HB80-5	80	12.7	16	22.2	18

Remark: Any other specification may available upon requirement.